

# 6-FM-75Ah



**LUXPOWER**  
CIA.LTDA.

## Valve-regulated Lead Acid Battery Specification

### Features

- Maintenance free
- Safety and no leakage
- Excellent recharge and discharge performance
- Low self-discharge rate
- Adapt to high or low temperature
- Good deep discharge performance
- Longer cycle life



### Specification

Rated Voltage	12V
Numbers of cells	6 Cells
Capacity	75Ah@20hr-rate to 1.75V per cell @25°C
Weight	22.5kg
Internal Resistance	Approx. 7 mΩ
Terminal	F15(M6) / F11(M6)
Max. Discharge Current	750A(5s)
Max. Charging Current	15A
Reference Capacity	C3 51.0AH C5 59.0AH C10 65.8AH C20 75.0AH
Design Life	10-15 years
Float Charging Voltage	13.5 V-13.8 V @ 25°C Temperature Compensation: -20mV/°C/Cell
Cycle Use Voltage	14.4 V-15 V @ 25°C Temperature Compensation: -30mV/°C/Cell
Operating Temperature Range	Discharge: -40°C-60°C Charge: -20°C-50°C Storage: -40°C-60°C
Normal Operating Temperature Range	25°C±5°C
Self Discharge	Less than 3% at 25°C per month
Container Material	A.B.S. UL94-HB, UL94-V0 Optional.

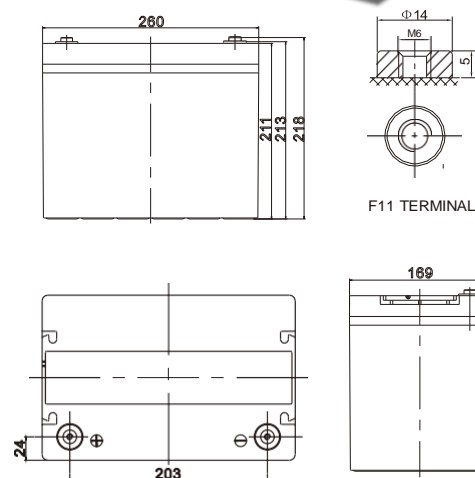

Length	260±1mm (10.2 inches)
Width	169±1mm (6.65 inches)
Height	211±1mm (8.31 inches)
Total Height	218±1mm (8.58 inches)

### Constant Current Discharge Characteristics : A(25°C)

F.V/Time	10MIN	15MIN	30MIN	1HR	2HR	3HR	4HR	5HR	8HR	10HR	20HR
1.60V/cell	139.0	108.8	71.5	41.9	25.1	17.3	14.3	12.1	8.25	6.84	4.13
1.65V/cell	132.3	106.5	70.3	41.7	24.9	17.2	14.3	12.0	8.18	6.78	3.98
1.70V/cell	127.6	104.9	69.7	41.3	24.7	17.1	14.2	11.9	8.11	6.71	3.86
1.75V/cell	119.1	101.0	69.9	41.0	24.5	17.0	14.1	11.8	8.05	6.64	3.75
1.80V/cell	109.9	94.2	69.3	40.0	24.1	16.6	13.7	11.6	7.91	6.58	3.53
1.85V/cell	99.4	85.5	65.5	38.0	23.0	15.9	13.1	11.1	7.58	6.38	3.38

### Constant Power Discharge Characteristics : WPC(25°C)

F.V/Time	10min	20min	30min	45min	1h	2h	3h	5h	8h	10h	20h
1.80V/cell	189.40	131.40	95.40	75.50	59.40	36.10	27.80	18.40	13.10	10.90	5.89
1.75V/cell	205.60	140.10	98.60	78.00	61.90	37.30	28.30	18.90	13.30	11.00	5.94
1.70V/cell	220.90	146.40	102.20	80.90	63.70	38.70	29.00	19.30	13.50	11.10	6.04
1.65V/cell	236.70	154.80	107.30	82.60	65.60	39.60	30.10	19.80	13.60	11.30	6.11
1.60V/cell	252.60	163.20	112.20	85.30	67.40	40.70	30.90	20.30	13.80	11.40	6.14

# 6-FM-75Ah

## Valve-regulated Lead Acid Battery Specification

Charge Characteristics for Float Use @ 25°C/77°F

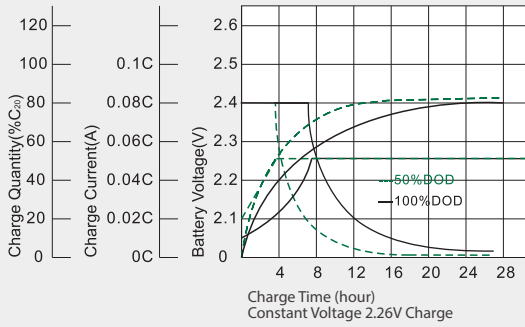

Discharge Characteristics at Various Rates @ 25°C/77°F

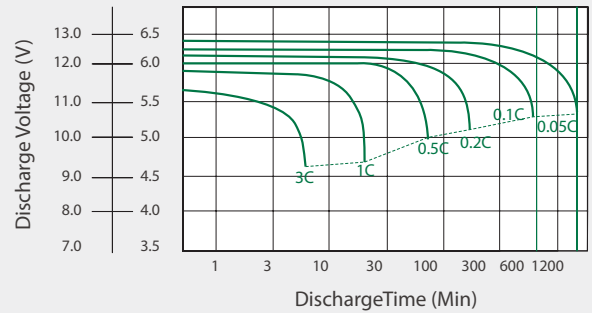

Cycle Life in Relation to Depth of Discharge

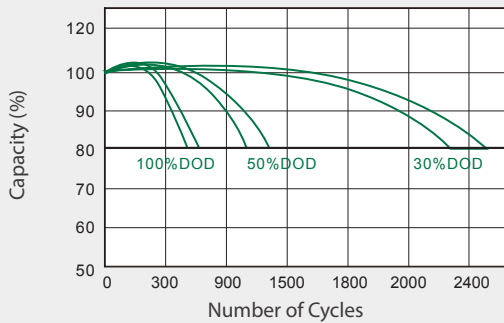

Float Service Life

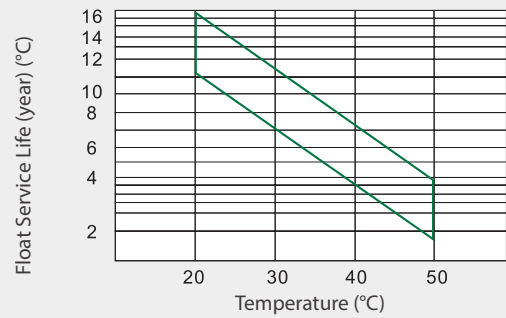

Temperature and Valid Capacity

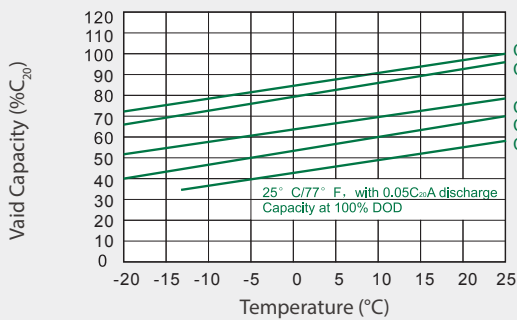

Self Discharge Characteristics

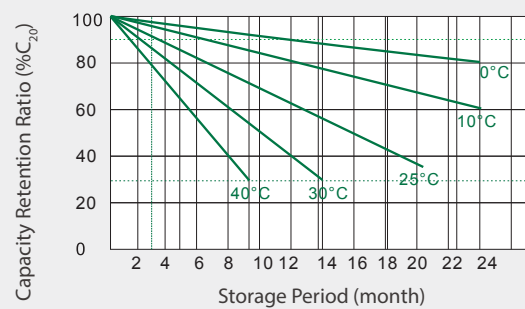

Capacity and Open Circuit Voltage

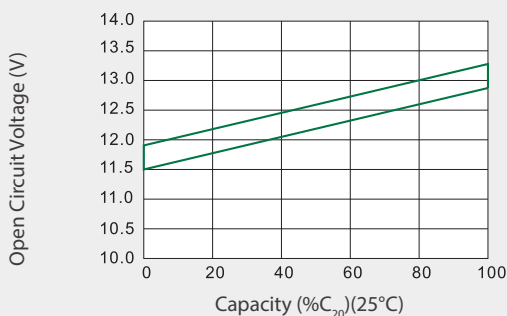

Relationship between Charging Voltage and Temperature

